

S C H E D U L E " A "

ALL AND SINGULAR that certain parcel or tract of land and premises, situate, lying and being in the Town of Pelham, in the Regional Municipality of Niagara, and being composed of Part of Block "C", Plan No. 16, now known as Plan 703 and which said parcel or tract may be more particularly described as follows;

ALL of Part 1 on a plan of survey deposited in the Registry Office for the Registry Division of Niagara South as 59R-3944.

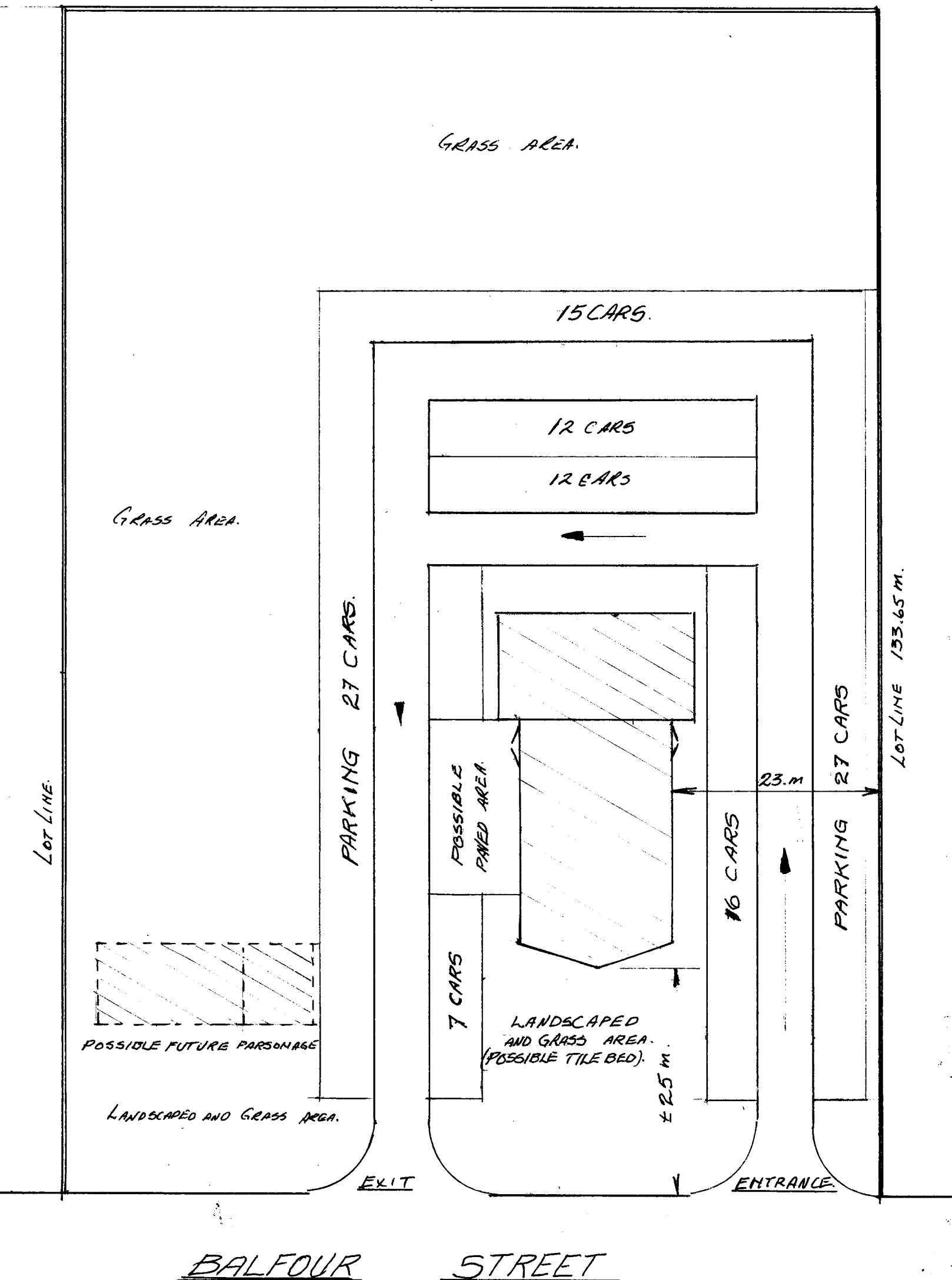

PROPOSED PLOT PLAN

OF THE BETHANY CHR. REFORMED CHURCH

PART 1 OF BLOCK C COMPILED
PLAN No 16. TOWN OF PELHAM.

SCALE: 1 CM = 5 M.

NOTICE OF SITE PLAN AGREEMENT

TAKE NOTICE that on the 8th day of June, 1983 A.D. Bethany Christian Reformed Church entered into a site plan agreement with the Corporation of the Town of Pelham which has the effect of restricting the use of the lands described in Schedule "A" attached hereto and forming part of this notice.

AND FURTHER take notice that the conditions, restrictions and covenants contained in the said site plan agreement may be examined at the Office of the Clerk of the Corporation of the Town of Pelham, 20 Pelham Town Square, Fonthill, Ontario in the original agreement which is attached to By-law #858 (1983) passed on the 6th day of June, 1983 A.D.

DATED at the Town of Pelham this 9th day of June, 1983 A.D.

Murray Hackett, Clerk

The Corporation of the Town of Pelham

SCHEDULE "A"

ALL AND SINGULAR that certain parcel or tract of land and premises, situate, lying and being in the Town of Pelham, in the Regional Municipality of Niagara, and being composed of Part of Block "C", Plan No. 16, now known as Plan 703 and which said parcel or tract may be more particularly described as follows;

ALL of Part 1 on a plan of survey deposited in the
Registry Office for the Registry Division of Niagara
South as 59R-3944.

